

C • O • N • T • E • N • T • S



1

PRECAUTION

Safety Precaution	2
Checklist	3

2

INSTRUCTIONS

Battery Replacement	4
Opening and Closing the Door	5
Inputting Your Personal Code	6
Erasing Your Personal Code	7
Changing to Locking Mode	8

3

OTHER INFORMATION

Trouble Shooting	9, 10
------------------------	-------

NOTICE

1. 1 hour fire protection certified by SP NT-Fire 017 60P, UL Class 350 1hour, KS 1 hour
2. Note your personal code anywhere else not to forget.
3. Install a safe to a well ventilated, dry and horizontal area.
4. Keep children out of mischief with a safe.



SAFETY PRECAUTIONS

Please read these instructions carefully and note the operational requirements and cautions.

Precaution is composed of 'Warning' and 'Caution'.



Warning: Failure to do so may cause serious damage and/or personal injury.



Caution: Failure to do so may cause minor damage and/or personal injury.



WARNING



Be careful when moving a safe. You may get hurt.



Be careful of bumped corners of a safe. You may get hurt.



CAUTION



Be careful when closing the door. Your finger may be pinched.



Be careful that a safe may cause scratches on the floor or table.

CHECKLIST



1. A malfunction may occur if keypad becomes moist or dirty with metallic alien substances.
2. Do not scratch or impact on the LCD display with a sharp objects.
3. Do not expose a safe to dangerous chemicals such as gasoline, benzene, solvent, acetone, thinner, or etc.
4. Do not apply direct heat or fire.
5. When not using a safe for a long time, remove batteries from a safe.
6. If you turn the handle excessivley, the handle may be damaged.

▶ Component

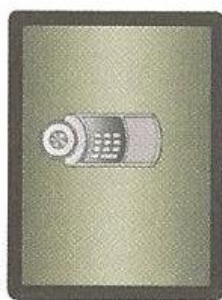

Safe Body



Drawer



1.5V Batteries
(AA X 4)



Instruction

▶ Keypad Overview

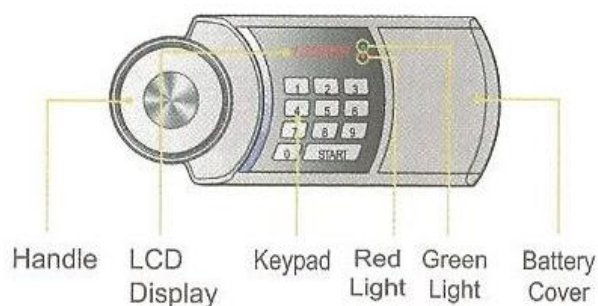

BATTERY REPLACEMENT



▶ TIME TO CHANGE BATTERIES

- 1 When the battery is low, "L_batt" will be shown on the LCD screen. You should replace the batteries immediately.
- 2 When you cannot open the door even if the code is entered correctly and the display reads "OPEn", replace the batteries.
- 3 When the "good" message is shown on the display along with a beep after entering the code correctly, replace the batteries.
- 4 When the LCD display doesn't show a message after pushing the START button, replace the batteries.

▶ REPLACING BATTERIES

- 1 Slide and remove the battery cover to the right.
- 2 Replace the old batteries with four 1.5V (size AA) Alkaline batteries. Ensure that the (+) and (-) positions are correct.
- 3 Place the battery cover back in its original position.

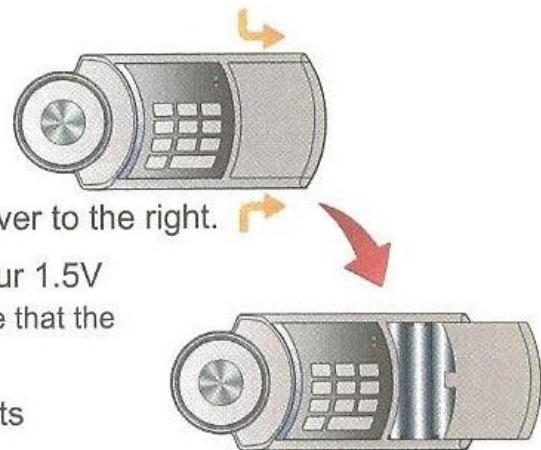

⚠ Warning: After replacing the batteries, ensure that the lock is working correctly before closing the door.

OPENING and CLOSING THE DOOR



- 1 Push the START button on the control panel.

"The panel will show '-----'"



NOTICE

- When you push the START button twice, the LCD display will change to Safety mode and will show a blank screen.



- 2 Enter the programmed factory code: 1,2,3,4,5,6

After entering the 6 numbers, the LCD display will read "OPEN".



NOTICE

- If the door is not opened within 4 seconds after the green light, the door will not open.
- If the START button is pushed before all 6 numbers are entered, input is cancelled and the correct codes can be reentered.
- If an incorrect code is entered, the display will show "Err-03"
- If an incorrect code is entered 5 times in a row, the safe will beep for 3 minutes.
- During the beep, if the START button is pushed and the correct code entered, the beeping will stop.



- 3 Turn the handle clockwise before the word "OPEN" disappears.



NOTICE

- When the display reads "Open" and the green light is on, but the door is still locked, change the batteries to new ones.



- 4 To close the door, turn the handle counterclockwise.

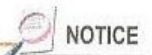

NOTICE

- After closing the door, check if the handle is locked correctly by turning the handle clockwise.



INPUTTING YOUR PERSONAL CODE



Caution The safe can be programmed with two personal codes. (User 1 / User 2)
Do not close the door until the new code has been tested.

- 1 Enter the code and open the door.

You can change the code only when the door is opened.

- 2 Press the (white) memory button located inside the door.

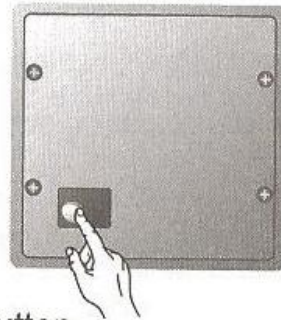

- 3 Press 1 or 2, then the START button.

To change the code of User 1, press 1 and the START button.
To change the code of User 2, press 2 and the START button.

- 4 Enter your new code (6 digits).

If the START button is pressed while entering the six digits,
the input will be cancelled and the new code can be reentered.

- 5 The new code is set up.

The LCD display will beep and show "In 1 (or 2)".

When the code of User 1 is changed, the LCD display will show "In 1".

When the code of User 2 is changed, the LCD display will show "In 2".

ERASING YOUR PERSONAL CODES



- 1 Enter the code and open the door.

The codes can be changed only when the door is opened.



NOTICE

- If the START button is pressed twice, the LCD display will not show the code for security.

- 2 Press the memory button inside the door.

"USER" will be displayed and "_" will blink.



NOTICE

- The (white) memory button is located inside the door.

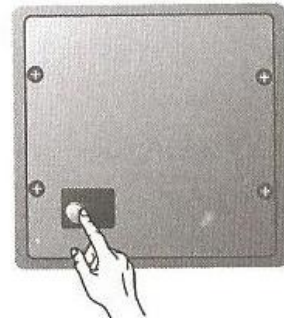

- 3 Press 2 and the memory button to erase your personal code.



NOTICE

- Only User 2 code can be erased.
- After erasing the User 2 code, only User 1 code can be used.
- To reuse User 2 code, follow the instructions for INPUTTING YOUR PERSONAL CODES.

CHANGING TO LOCKING MODE



- 1 Simultaneously press 0 and the START button and hold for 3 seconds.



- 2 When "Lock" is shown on the LCD display, the locking mode is activated.

The mode is activated, the keypad is locked and the display shows "Loct".

- 3 To change to standard mode, simultaneously press 0 and the START button and hold for 3 seconds.

- 4 "Act" is shown on the display, and the standard mode is activated again.



NOTICE

- The locking mode will continue even after batteries are removed.

TROUBLE SHOOTING



PROBLEM	FACTOR	SOLUTION
The START button is not working.	<ul style="list-style-type: none"> Needs replacement batteries Poor battery connection The locking mode is activated. Failure in PCB 	<ul style="list-style-type: none"> Change batteries to new ones and try again. Check if the batteries were inserted properly. Simultaneously press 0 and the START button and hold for 3 seconds, and then unlock the locking mode. Contact the service department of the local retailer.
The beeping doesn't stop.	<ul style="list-style-type: none"> The incorrect code has been entered 5 times. 	<ul style="list-style-type: none"> Try the correct code. After 3 minutes, the beeping will stop and it will return to its standard state.
The green light and "OPEN" message are on, but the door won't open.	<ul style="list-style-type: none"> Needs replacement batteries Turn the handle counterclockwise. Failure in lock system. 	<ul style="list-style-type: none"> Change batteries to new ones and try again. Turn the handle clockwise. Contact the service department of the local retailer.
The previous codes have not changed to new ones.	<ul style="list-style-type: none"> Time lag while changing the code. Wrong procedure in changing or deleting the code. The wrong code was changed or deleted on the previous attempt. Button failure 	<ul style="list-style-type: none"> After pressing the memory button or the START button, enter the new code within 5 seconds. Follow the instruction on page 6 or 7 and try again. Check if User 1 or User 2 code has changed. Contact the service department of the local retailer.
"Err-03" message is shown on the LCD display.	<ul style="list-style-type: none"> An incorrect code was entered. An error occurred repeatedly. 	<ul style="list-style-type: none"> Try the correct code. If the correct code is entered, the error sign will disappear.

TROUBLE SHOOTING



PROBLEM	FACTOR	SOLUTION
"L_batt" message is shown on the LCD display.	<ul style="list-style-type: none">Needs replacement batteries.	<ul style="list-style-type: none">Change batteries to new ones and try again.
"Lock" message is shown on the LCD display.	<ul style="list-style-type: none">The locking mode is activated.	<ul style="list-style-type: none">Simultaneously press 0 and the START buttons, hold for 3 seconds and unlock the locking mode.
"no con" message is shown on the LCD display.		<ul style="list-style-type: none">Contact the service department of the local retailer.
When you lose your personal code		<ul style="list-style-type: none">Contact the service department of the local retailer.